



jordan fishwick

Abbots Court



Abbots Court, M33 2DB

£1,195 PCM



The Property

*** AVAILABLE NOW *** A TWO DOUBLE BEDROOM first floor apartment situated in a very popular development, close to Dane Road Metrolink, Sale Town Centre and local amenities. The internal accommodation comprises briefly: communal entrance hallway, private hallway, lounge/ dining room, modern fitted kitchen, two double bedrooms and bathroom with three piece suite. Benefitting from double glazing and is warmed by gas central heating. Externally there is ample car parking for residences and visitors, communal gardens and private garage with up and over door. Offered on an Unfurnished basis. Council Tax Band B. EPC Rating C. Call now to view - 0161 929 9797

Directions

M33 2DB



- Two Bed Apartment
- Modern Kitchen and Bathroom
- First Floor
- Un furnished
- Available December
- Epc rating C
- Walking Distance To Tram Stop
- Communal Gardens
- Views To The Rear Over Cricket Ground

Postcode - M33 2DB

EPC Rating - C

Floor Area - sq ft

Local Authority - Trafford

Council Tax - B



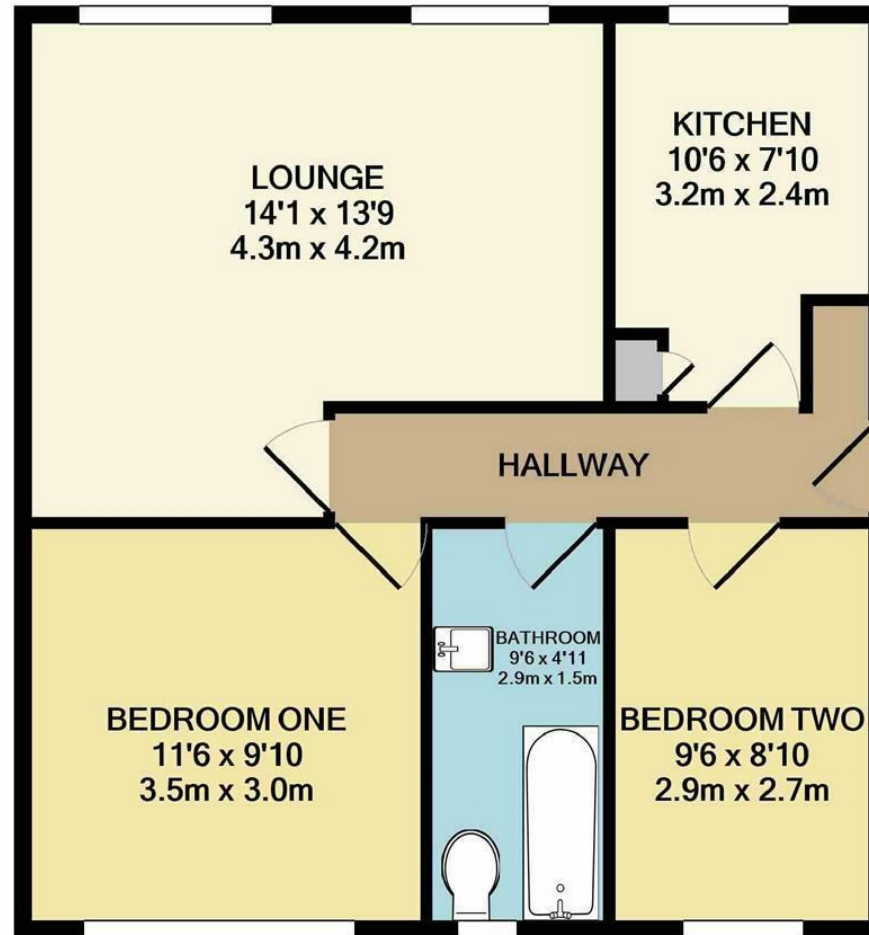

TOTAL APPROX. FLOOR AREA 566 SQ.FT. (52.6 SQ.M.)
 Measurements are approximate. Not to scale. Illustrative purposes only
 Made with Metropix ©2020



These particulars are believed to be accurate but they are not guaranteed and do not form a contract. Neither Jordan Fishwick nor the vendor or lessor accept any responsibility in respect of these particulars, which are not intended to be statements or representations of fact and any intending purchaser or lessee must satisfy himself by inspection or otherwise as to the correctness of each of the statements contained in these particulars. Any floorplans on this brochure are for illustrative purposes only and are not necessarily to scale.

Offices at: Chorlton, Didsbury, Disley, Hale, Glossop, Macclesfield, Manchester Deansgate,
 Manchester Whitworth Street, New Mills, Sale, Wilmslow and Withington

01619291994

halemanagement@jordanfishwick.co.uk
 www.jordanfishwick.co.uk